

7/97

ULTRA SUPREME[®]

GULF STREAM

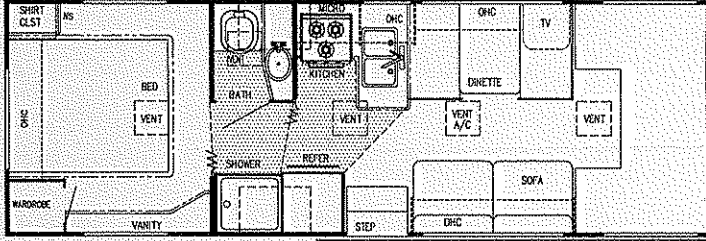

Model 6272 Wide-Body (Twin Beds or Bunks Opt.)

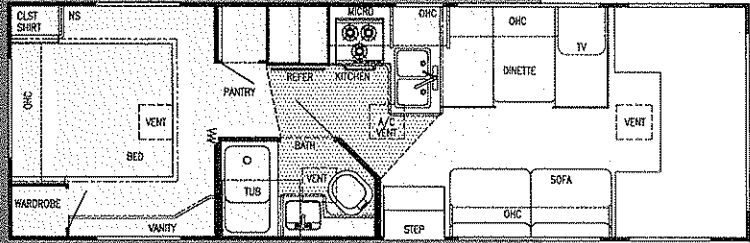

Model 6293 Wide-Body (Twin Beds or Bunks Opt.)

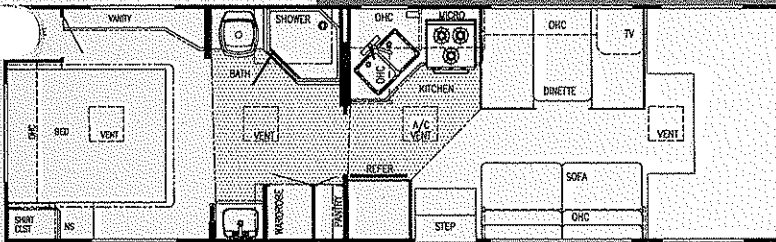

Model 6301 Wide-Body (Twin Beds or Bunks Opt.)

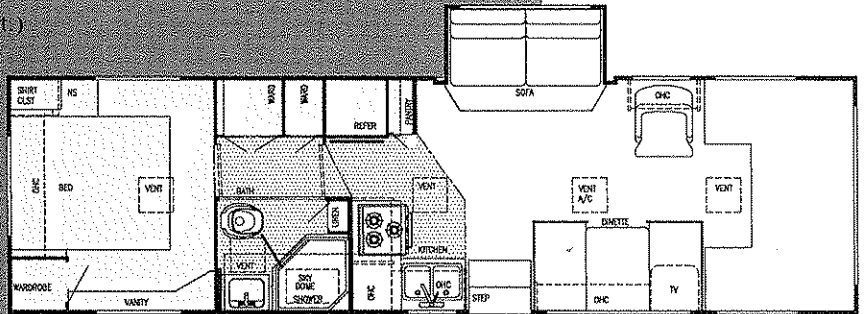

Model 6311 Wide-Body (Twin Beds or Bunks Opt.)

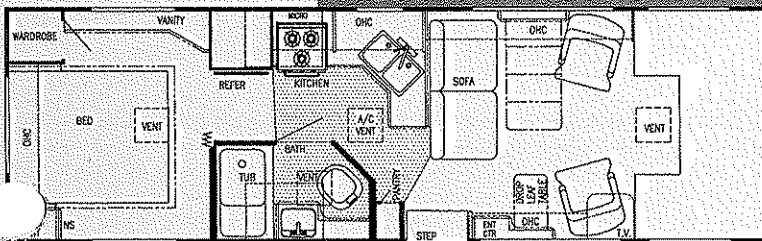

Model 6300 Wide-Body (Twin Beds or Bunks Opt.)

SUPREME®

Standard Specifications

Interior and Decor

- 6' - 5" Interior Height (most models)
- Stile Constructed Cabinetry
- Natural Oak, Raised Panel Mortise and Tenon Cabinet Doors
- Privacy Curtain Cab
- Interior Decorative Clock
- Queen Size Bed, Cab-Over
- 3-Way Driver & Passenger Seats
- Deluxe Carpet W/Pad Throughout
- Coordinated Bedspread & Shams
- Power Vent in Commode
- Generous Overhead Storage
- Mini Blinds in Kitchen
- Hide-a-Bed Sofa (6311)
- Hydraulic Operated Glide-Out Room (6311)
- Soft Touch Interior Ceiling Fabric
- Designer Interior Window Treatments
- Cab-Over Entertainment Center

Electrical Systems

- Easy-Store 25' Elect. Power Cord
- Lighted Basement Storage
- Overhead Reading Lights
- 110V Receptacles
- Generator prep
- Ground Fault Circuit Interrupter
- Outside Receptacle
- Auxiliary Battery
- Converter w/Charger
- AM/FM Cassette w/4 Speakers
- Monitor Panel

Exterior and Construction

- Welded Aluminum Cage Construction
- High Density Block Foam Insulation in the Walls, Roof & Floor
- Super-Slick Laminated Mende Board Fiberglass Exterior
- Radiused Laminated Rubber Roof w/ Heliarc-Welded Aluminum Rafters
- Exclusive Molded Roof Brick Insulation
- Tubular Steel Floor
- Laminated Floor w/Metal Underbelly
- Foamed, Sealed & Undercoated Subfloor
- Fiberglass Front and Rear Caps & Wings
- Full Basement Storage
- Carpeted Basement Storage Compartments
- Distinctive Exterior Graphics
- Expansive Radius Slider Windows
- Front Cab-Over Window
- Outside Grab Handle
- Porch Light
- Dead-Bolt on Entry Door
- Rubber Entry Step
- Spare Tire and Wheel
- Smart-Ryde Suspension System by MOR/ryde (on model 6311)
- Maximum Width Floorplans
- Fully-Enclosed Black, Grey and Fresh Water Tanks

Bath and Water

- Demand Water System
- City Water Hook-Up
- Tub/Shower Combination
- Bath Convenience Accessories
- Lavatory w/base Cabinet Storage

Chevrolet Chassis (6311 Only)

- 454 Vortex Engine
- 4 Speed Auto. Overdrive Trans.
- Tilt Wheel Steering
- Power Brakes & Steering
- Radial Tires
- Cruise Control
- Gas Tank - Approx. 55 Gal.

Ford Chassis

- 6.8L, V-10 Engine
- E-40 Super Duty Chassis
- 4 Speed Auto. Overdrive Trans.
- Tilt Wheel Steering
- Power Brakes & Steering
- Deluxe Heated & Remote Mirrors
- Power Locks and Windows
- Radial Tires
- Cruise Control
- Gas Tank - Approx. 55 Gal.
- FORD Turbo Diesel Chassis (Opt.)
- Dual Air Bags

Appliances

- 3-Burner Range w/High Output Burner
- Range Hood w/Monitor Panel
- Carbon Monoxide Detector
- Microwave Standard
- 6 Gal. Quick-Recovery Water Heater
- 25,000 BTU Furnace (30,000 - 6311)
- 13,500 BTU Ceiling Ducted A/C
- Convection Oven (Opt.)

Deluxe Standard Features

- Oak Drink Tray (Ford)
- Oak Sink Cover
- Oak Knife Holder
- Slide Out Cabover Bunk
- Foam Seal & Undercoating
- Acrylic Entry Door Assist Bar
- Lighted Trunk Boxes
- Auxiliary Battery

MODEL	Chassis	Wheel Base	GWR	*Length	*Height (w/A/C)	*Black	*Gray	*Fresh	LP Tank	*Basement Storage
6272	Ford Super Duty V-10	186	14,050	28' - 0"	11' - 3"	46	39	47	68 lb.	95.3 cu. ft.
6293	Ford S.D. V-10	208	14,050	29' - 5"	11' - 3"	39	39	39	68 lb.	111.4 cu. ft.
6300	Ford S.D. V-10	208	14,050	30' - 4"	11' - 3"	39	39	47	68 lb.	111.3 cu. ft.
6301	Ford S.D. V-10	208	14,050	30' - 8"	11' - 3"	46	39	47	68 lb.	107.3 cu. ft.
6311	Chevy 454 Vortex	202+tag	15,000	32' - 5"	11' - 3"	46	39	34	68 lb.	75.1 cu. ft.

* - Approximate, and subject to change without notice.



GULF STREAM COACH, INC.
P.O. BOX 1005 • NAPPANEE, IN 46550

For further information, contact your local dealer or Gulf Stream. Gulf Stream Coach, Inc., reserves the right to make changes in prices, colors, materials, components and specifications and to discontinue models at any time without notice or obligation. Gulf Stream Coach, Inc., assumes no responsibility for any error in type or print reproduction of specifications or floorplans in this brochure.

TP 30M 7/97 Printed in U.S.A.

Visit our Web Site at:
www.GULFSTREAMCOACH.com

ULTRA LE[®]

GULF STREAM

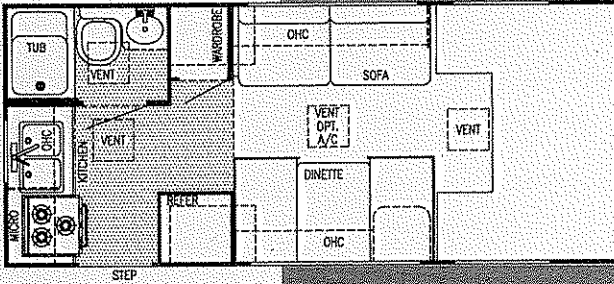

Model F6200

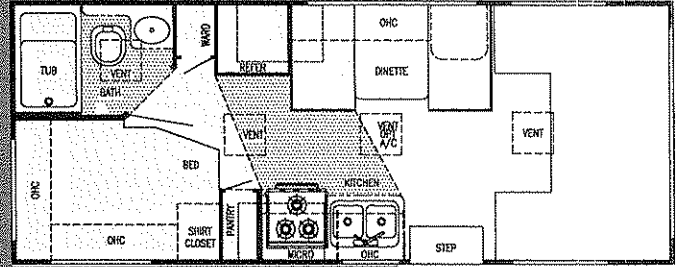

Model F6210

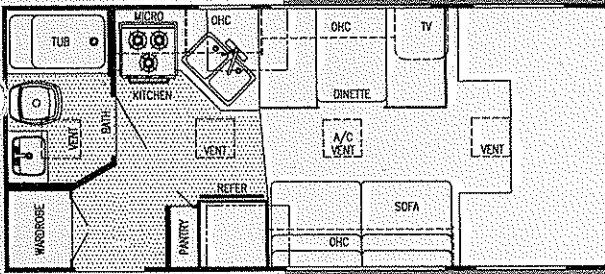

Model W6211

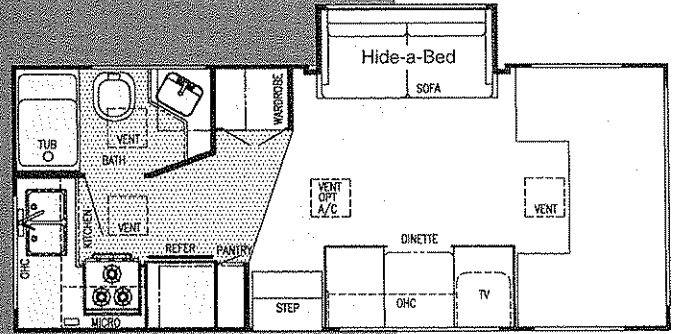

Model W6236

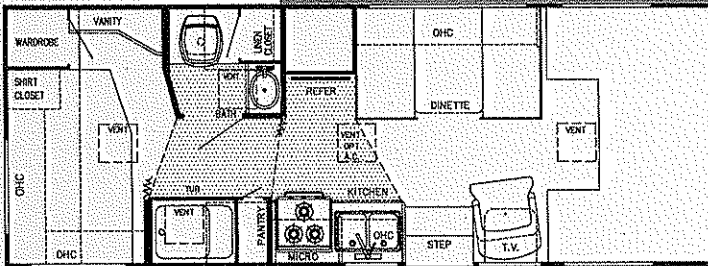

Model W6242 (Wide Body)

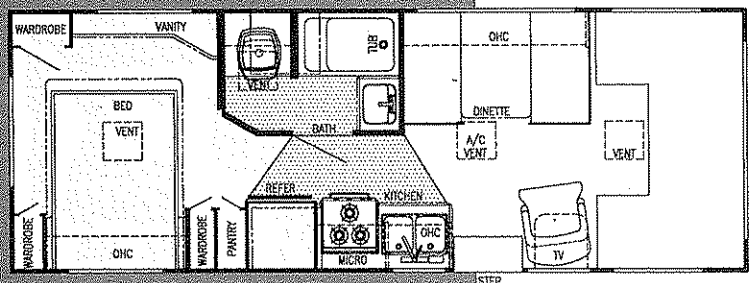

Model W6265 (Twin Beds or Bunks Opt.)

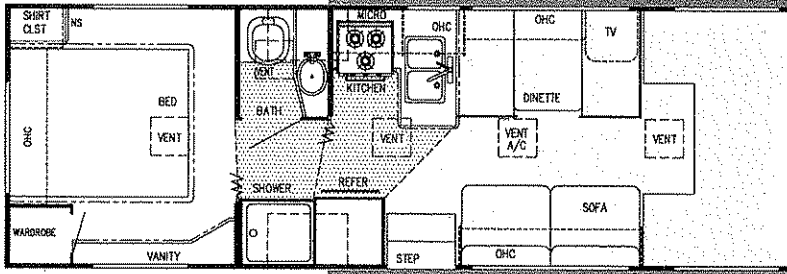

Model W6272 (Twin Beds or Bunks Opt.)

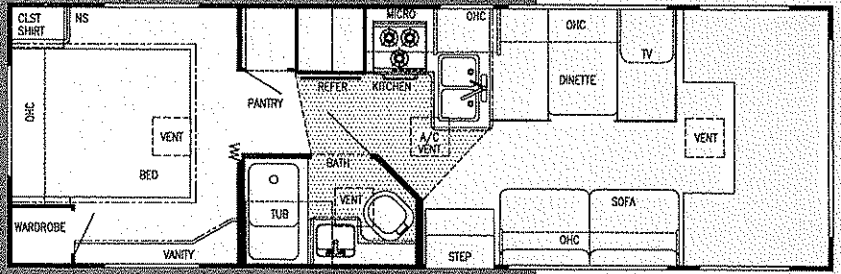

Model W6293 (Twin Beds or Bunks Opt.)

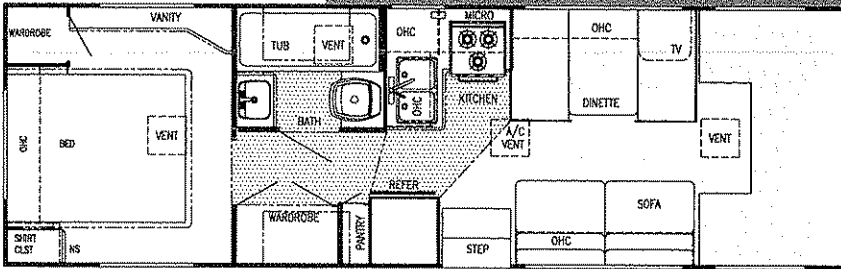

Model W6294 (Twin Beds or Bunks Opt.)

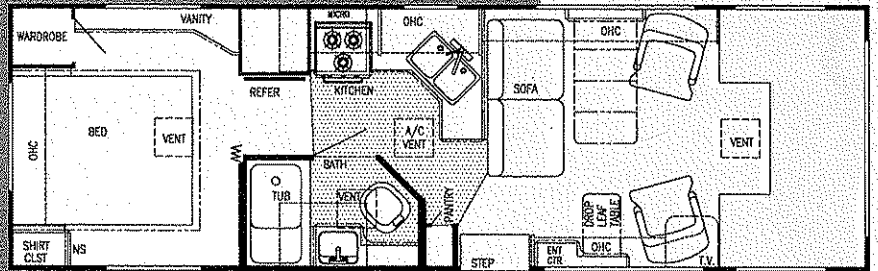

Model W6300 (Twin Beds or Bunks Opt.)

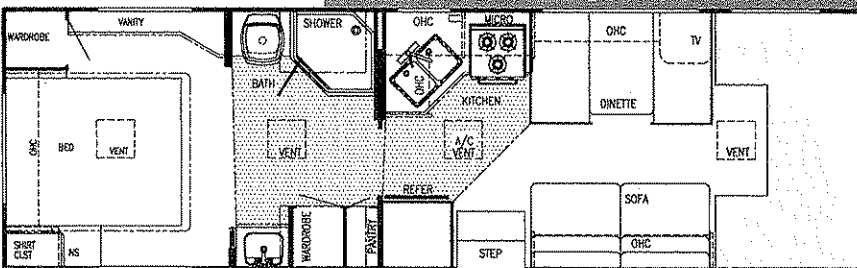

Model W6301 (Twin Beds or Bunks Opt.)

ULTRA LE[®]

GULF STREAM

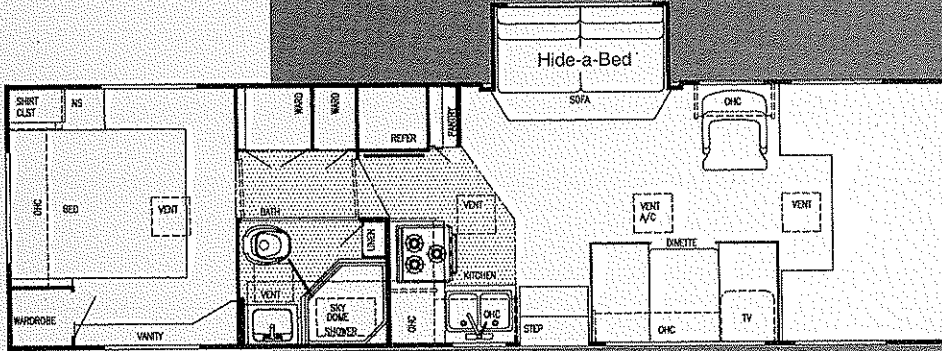

Model 6311 (Twin Beds or Bunks Opt.)

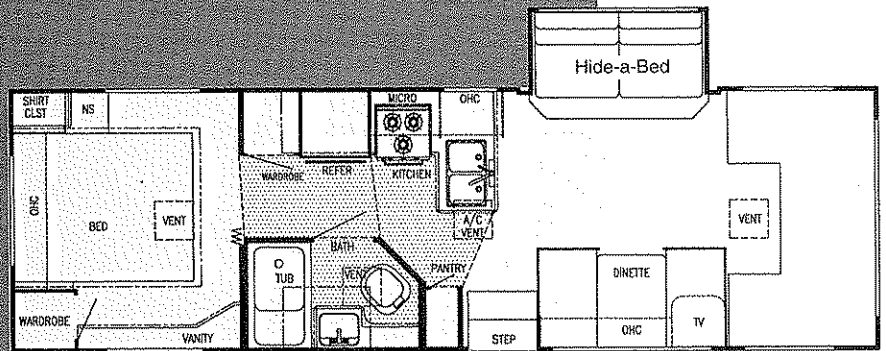

Model 6312 (Twin Beds or Bunks Opt.)

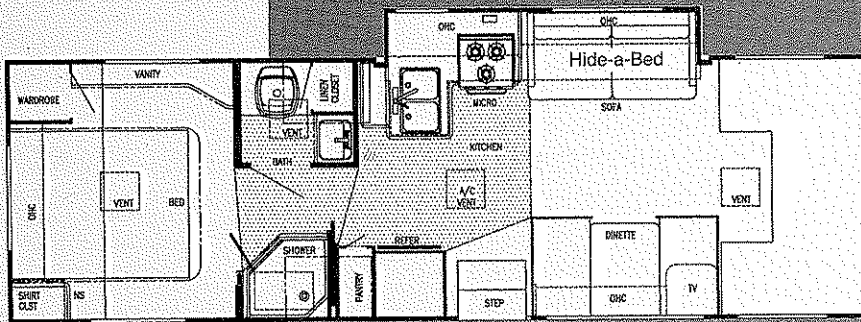

Model 6313 (Twin Beds or Bunks Opt.)

OPTIONS

Twin Beds (Nightstand)

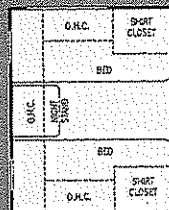

Twin Beds (Wardrobe)

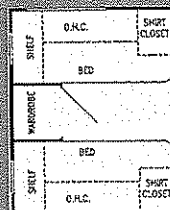

Bunk Beds

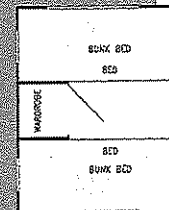

Bunk/Dinette

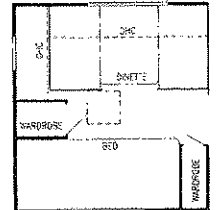

LIMITED EDITION

By GULF STREAM®

Standard Specifications

Interior and Decor

- Approx. 6'-5" Interior Height (Most Models)
- Stile Constructed Cabinetry
- Natural Oak Frame Raised Panel Cabinet Doors
- Privacy Curtain Cab
- Deluxe Carpet w/Pad Throughout
- Generous Overhead Storage
- 3-Way Driver & Passenger Seat
- Coordinated Bedspreads & Shams
- Decorator Curtains & Shades w/Valances
- Brass Accent Trim on Overhead Doors
- Interior Decorative Clock
- Rubber Entry Step
- Queen Size Bed, Cab-Over
- Power Vent in Commode
- Tile Tub Surround
- Mini Blinds Kitchen & Bath
- Hide-A-Bed Sofa (6236, 6311, 6312, 6313)
- Hydraulic-Operated Glide Out Room (6236, 6311, 6312, 6313)

Electrical Systems

- Easy Store 25' Elect. Power Cord
- Overhead Reading Lights
- 110-Volt Receptacles
- Ground Fault Circuit Interrupter
- Well Illuminated Interiors
- Outside Receptacle
- TV Antenna w/Amp & Boost
- Auxiliary Battery
- Converter w/Charger
- Generator Prep
- AM/FM Cassette w/4 Speakers
- Monitor Panel
- Convection Oven (Opt.)

Exterior and Construction

- Welded Aluminum Cage Construction
- 4-Ply Laminated Walls, Roof & Floor
- Dura-Tech Fiberglass Exterior
- Radiused Laminated Rubber Roof w/ Heliarc-Welded Aluminum Rafters
- Exclusive Molded Roof Brick Insulation System w/Bubble Wrap Duct System
- Hydraulic Pump Override System
- Tubular Steel Floor
- Laminated Floor w/ Metal Underbelly
- Foamed, Sealed & Undercoated
- Full Basement Storage (most models)
- Distinctive Exterior Graphics
- Expansive Radius Slider Windows
- Hose Storage Bumper
- Front Cab-Over Window
- Outside Grab Handle
- Porch Light • Chrome Bumper Cover
- Aluminum Running Boards
- Dead Bolt on Entry door
- Spare Tire Carrier
- Roof Rack & Ladder
- Smart-Ryde Suspension System by MOR/ryde (6311 only)
- Bumper Jack (6313 only)

Bath and Water

- Demand Water System
- City Water Hook-Up
- Tub/Shower Combo
- Lavatory w/Base Cabinet Storage
- Bath Convenience Accessories
- Skydome in Shower (6311 & 6301)

Chevrolet Chassis (6311 Only)

- 454 Vortex Engine
- 4 Speed Auto. Overdrive Trans.
- Tilt Wheel Steering
- Power Brakes & Steering
- Radial Tires
- Cruise Control
- Gas Tank - Approx. 55 Gal.

Ford Chassis

- 6.8L, V-10 Engine
- E-30 Chassis (Up to 26')
- E-40 Super Duty Chassis (27' & above)
- 4 Speed Auto. Overdrive Trans.
- Tilt Wheel Steering
- Power Brakes & Steering
- Deluxe Exterior Mirrors
- Radial Tires
- Cruise Control
- Gas Tank - Approx. 35 Gal. (21')
Approx. 55 Gal. (24' & up)
- FORD Turbo Diesel Chassis (Opt.)
- Dual Air Bags

Appliances

- 3-Burner Range
- Large 2-Way Dbl. Door Refer.
- Microwave Installed
- 6 Gal. Elect. Ign. Water Heater
- 25,000 BTU Furnace - most models (30,000 BTU - 30' & above)
- 13,500 BTU Roof Air
- Large LP Gas Tank

For more information, contact your local dealer or Gulf Stream. Gulf Stream Coach, Inc., reserves the right to make changes in prices, colors, materials, components and specifications and to discontinue models at any time without notice or obligation. Gulf Stream Coach, Inc., assumes no responsibility for any error in type or print reproduction of specifications or floorplans in this brochure. TP: 30M 7/97

MODEL	Chassis	Wheel Base	GVWR	*Length	*Height (w/A/C)	*Black	*Gray	*Fresh	*Basement Storage	LP Tank
6200	Ford E-30 V-10	138	10,500	20' - 8"	10' - 7"	19	19	20	N/A	41 lb.
6210	Ford E-30 V-10	138	10,500	22' - 2"	10' - 9"	16	20	29	N/A	41 lb.
6211	Ford E-30 V-10	138	10,500	22' - 4"	10' - 9"	25	20	32	N/A	41 lb.
6236	Ford E-30 V-10	176	11,500	23' - 9"	11' - 1"	44	24	38	N/A	41 lb.
6242	Ford E-30 V-10	176	11,500	25' - 2"	10' - 9"	25	20	38	N/A	41 lb.
6265	Ford E-30 V-10	176	11,500	26' - 11"	10' - 9"	25	20	36	N/A	41 lb.
6272	Ford Super Duty V-10	186	14,050	28' - 3"	11' - 3"	46	39	47	95.3 cu. ft.	68 lb.
6293	Ford S.D. V-10	208	14,050	29' - 4"	11' - 3"	39	39	39	111.4 cu. ft.	68 lb.
6294	Ford S.D. V-10	208	14,050	30' - 1"	11' - 3"	39	39	39	111.8 cu. ft.	68 lb.
6300	Ford S.D. V-10	208	14,050	30' - 4"	11' - 3"	39	39	47	111.3 cu. ft.	68 lb.
6301	Ford S.D. V-10	208	14,050	30' - 8"	11' - 3"	46	39	47	107.3 cu. ft.	68 lb.
6311	Chevy 45 Vortex	202+41"	15,000	32' - 5"	11' - 3"	46	39	34	75.1 cu. ft.	68 lb.
6312	Ford S.D. V-10	208	14,050	30' - 8"	11' - 3"	39	39	47	74.2 cu. ft.	68 lb.
6313	Ford S.D. V-10	208	14,050	30' - 8"	11' - 3"	46	39	39	74.2 cu. ft.	68 lb.

* - Approximate, and subject to change without notice.

1100 SERIES[®]

GULFSTREAM

ULTRA

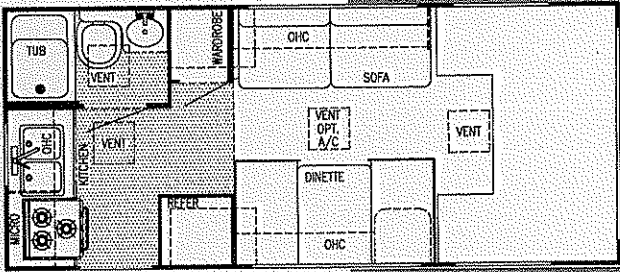

Model F6200

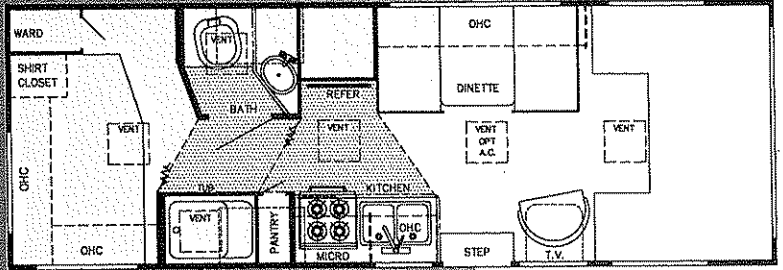

Model F6242

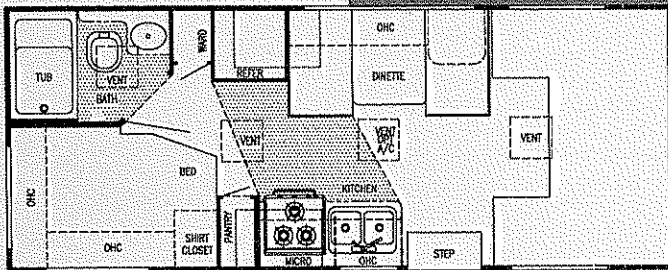

Model F6210

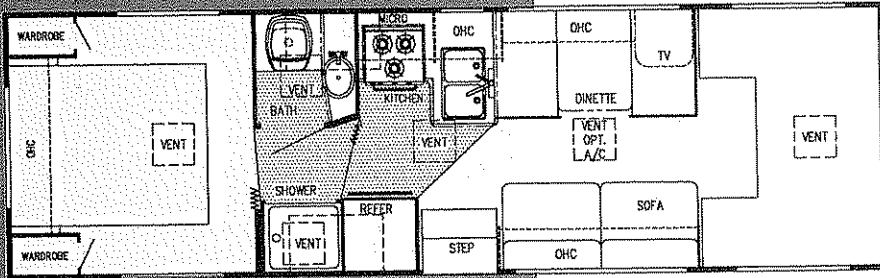

Model F6272/6272HR (Twin Beds, Slider Bed or Bunks Opt.)

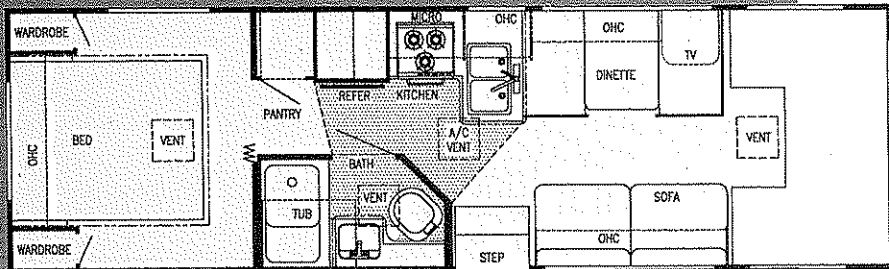

Model F6293HR (Twin Beds or Bunks Opt.)

1100 SERIES

Standard Specifications

Interior and Decor

- 6'-8" Interior Height (Most Models)
- Stile Constructed Cabinetry
- Raised-Panel Ridgmont Oak Cabinet Doors
- Rubber Stepwell
- Privacy Curtain Cab
- Deluxe Carpet w/Pad Throughout
- Generous Overhead Storage
- 3-Way Driver & Passenger Seat
- Coordinated Bedspreads & Shams (opt.)
- Decorator Curtains & Shades w/ Valances
- Queen Size Bed, Cab-Over
- Power Vent in Commode
- Tile Tub Surround

Electrical Systems

- o Easy Store 25' Elect. Power Cord
- o Overhead Reading Lights
- o 110-Volt Receptacles
- o Ground Fault Circuit Interrupter
- o Well Illuminated Interiors
- o Outside Receptacle
- o TV Antenna w/Amp & Boost
- o Auxiliary Battery
- o Converter w/Charger
- o Generator Prep
- o AM/FM Cassette w/4 Speakers
- o Monitor Panel

Exterior and Construction

- Smooth Fiberglass Exterior
- Rear Ladder
- Chrome Bumper Cover
- Aluminum Running Boards
- Deluxe Awning
- Welded Aluminum Cage Construction
- 4-Ply Laminated Walls, Roof & Floor
- Laminated Rubber Roof w/ Heliarc-Welded Aluminum Rafter
- Tubular Steel Floor
- Laminated Floor w/ Metal Underbelly
- Foamed, Sealed & Undercoated
- Generous Above-Floor Exterior Storage
- Partial Basement Storage Available (some models)
- Distinctive Exterior Graphics
- Expansive Radius Slider Windows
- Hose Storage Bumper
- Self Storing Entry Step
- Front Cab-Over Window
- Outside Grab Handle
- Porch Light
- Dead Bolt on Entry door
- Spare Tire Carrier
- Mag-Look Wheel Covers
- Full Basement (6272HR, 6293HR)

Bath and Water

- Demand Water System
- City Water Hook-Up
- Tub/Shower Combo
- Lavatory w/Base Cabinet Storage

Ford Chassis

- 6.8L, V-10 Engine
- 4 Speed Auto. Overdrive Trans.
- Tilt Wheel Steering
- Power Brakes & Steering
- Dual Air Bags
- Deluxe Exterior Mirrors
- Radial Tires
- Cruise Control
- Gas Tank -
Approx. 35 Gal. (20' - 21')
Approx. 55 Gal. (23' & Larger)
- E-30 Chassis (6200, 6210, 6242, 6272)
- Super-Duty (6272HR, 6293HR)
- FORD Turbo Diesel Chassis Opt
- Dual Air Bags

Appliances

- Microwave Installed
- 3-Burner Range
- Large 2-Way Sgl. Door Refer. (20' - 21')
- Large 2-Way Dbl. Door Refer. (23' - 27')
- 6 Gal. Elect. Ign. Water Heater
- 25,000 BTU Furnace
- 13,500 BTU Roof Air
- Large LP Gas Tank
- Carbon Monoxide Detector

Gulf Stream Coach, Inc. reserves the right to make changes in prices, colors, materials, components and specifications and to discontinue models at any time without notice or obligation. Gulf Stream Coach, Inc. assumes no responsibility for any error in type or print reproduction of specifications or floorplans in this brochure. TP 30M 7/97

MODEL	Chassis	Wheel Base	GVWR	*Length	*Height (w/A/C)	*Black	*Gray	*Fresh	LP Tank
6200	Ford E-30 V-10	138	10,500	20' - 8"	10' - 7"	19	19	20	41 lb.
6210	Ford E-30 V-10	138	10,500	22' - 2"	10' - 9"	16	20	29	41 lb.
6242	Ford E-30 V-10	176	11,500	25' - 4"	10' - 8"	19	25	38	41 lb.
6272	Ford E-30 V-10	186	11,500	28' - 0"	11' - 1"	46	46	47	41 lb.
6272HR	Ford E-40 V-10	186	14,050	28' - 0"	11' - 3"	46	46	47	41 lb.
6293HR	Ford E-40 V-10	208	14,050	29' - 4"	11' - 3"	34	34	39	41 lb.

* Approximate, and subject to change without notice.



GULF STREAM COACH, INC.
P.O. BOX 1005 • NAPPANEE, IN 46550

Visit our Web Site at:
www.GULFSTREAMCOACH.com